

DATE FILED: July 13, 2017

DISTRICT COURT, WELD COUNTY, COLORADO Court Address: 915 10 th Street Greeley, CO 80631 Telephone: (970) 475-2400	DATE FILED: July 13, 2017 CASE NUMBER: 2008CV243
Petitioner: MINER'S VILLAGE METROPOLITAN DISTRICT NO. 2	▲ COURT USE ONLY ▲
By the Court:	Case Number: 2008CV243 Division: 4 Courtroom:
ORDER GRANTING MOTION TO CHANGE NAME OF MINER'S VILLAGE METROPOLITAN DISTRICT NO. 2 TO SILVERSTONE METROPOLITAN DISTRICT NO. 2	

THIS MATTER comes before the Court on a Motion filed by Miner's Village Metropolitan District No. 2 for an Order changing the name of Miner's Village Metropolitan District No. 2 to SilverStone Metropolitan District No. 2. This Court, being fully advised in the premises and there being no objection filed by any person, hereby ORDERS:

That the name of Miner's Village Metropolitan District No. 2, which encompasses the property described in the attached Exhibit A, incorporated herein by reference, is hereby changed to SilverStone Metropolitan District No. 2, effective as of the date of this Order.

SO ORDERED this 10th day of July, 2017.

BY THE COURT:

[Signature]
 DISTRICT COURT JUDGE

Certified to be a full, true and correct
 copy of the original in my custody.

Dated 07/13/2017

Rachael Erickson
 Clerk of the District/County Court
 Weld County, Colorado

[Signature]
 Deputy

1191.0002; 829362



EXHIBIT A

LEGAL DESCRIPTION OF THE PROPERTY CONCERNED

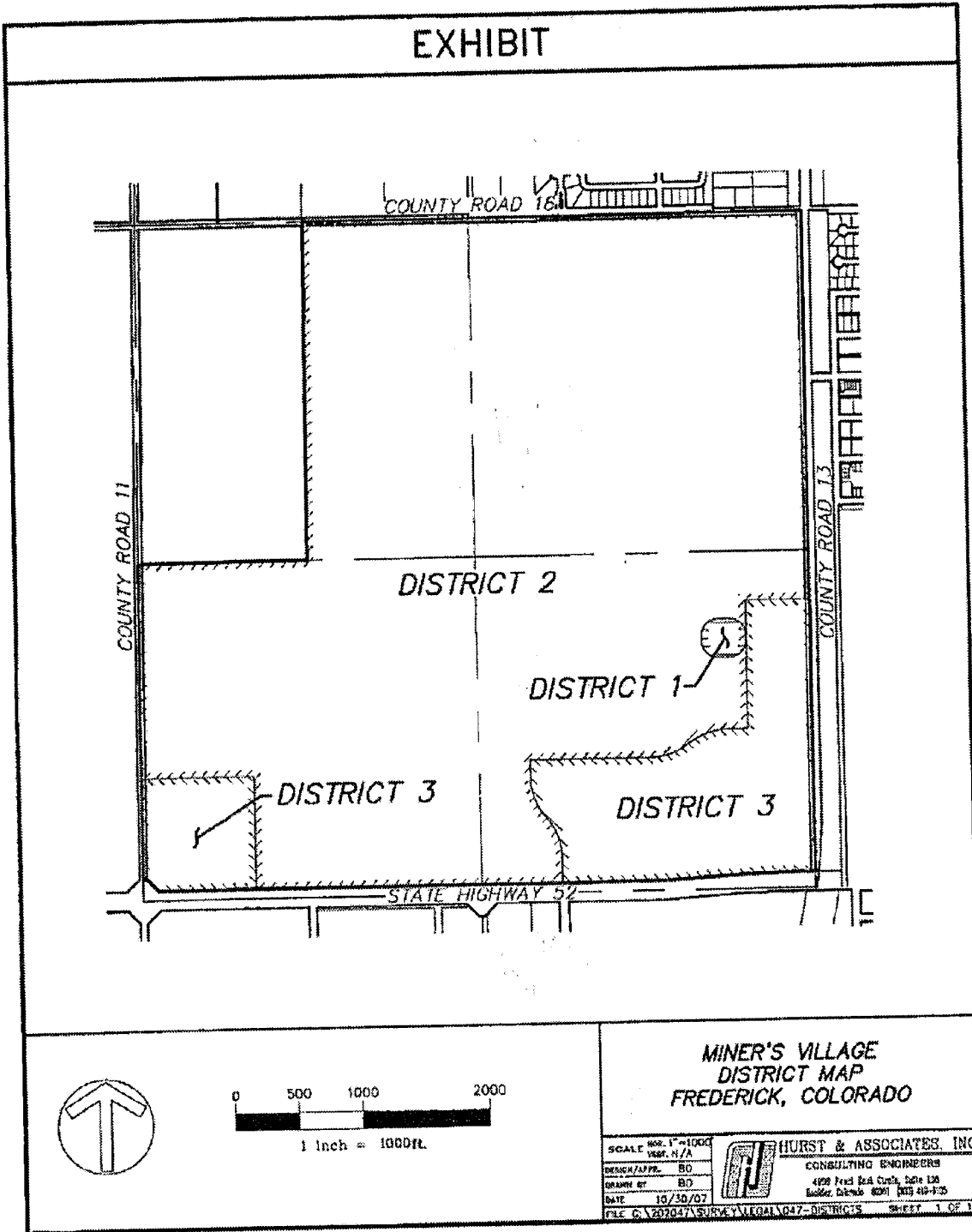

EXHIBIT

DISTRICT 2 DESCRIPTION:

A PARCEL OF LAND LOCATED IN SECTION 36, TOWNSHIP 2 NORTH, RANGE 68 WEST OF THE 6TH P.M., TOWN OF FREDERICK, COUNTY OF WELD, STATE OF COLORADO DESCRIBED AS FOLLOWS:

BEGINNING AT THE EAST QUARTER CORNER OF SAID SECTION 36 FROM WHENCE THE NORTHEAST CORNER LIES N00°07'13"W, 2,656.28 FEET (BASIS OF BEARINGS);
 THENCE S00°07'17"E, 383.29 FEET ALONG THE EASTERLY LINE OF THE SOUTHEAST QUARTER OF SECTION 36;
 THENCE S89°52'43"W, 501.40 FEET;
 THENCE S00°00'00"E, 1,025.16 FEET;
 THENCE S89°52'43"W, 184.98 FEET;
 THENCE 263.50 FEET ALONG THE ARC OF A TANGENT CURVE TO THE LEFT, SAID ARC SUBTENDED BY A RADIUS OF 475.00 FEET, A CENTRAL ANGLE OF 31°47'02", AND A CHORD BEARING S73°59'12"W, 260.13 FEET;
 THENCE S58°05'41"W, 102.25 FEET;
 THENCE 264.50 FEET ALONG THE ARC OF A TANGENT CURVE TO THE RIGHT, SAID ARC SUBTENDED BY A RADIUS OF 475.00 FEET, A CENTRAL ANGLE OF 31°54'19", AND A CHORD BEARING S74°02'50"W, 261.10 FEET;
 THENCE S90°00'00"W, 948.60 FEET;
 THENCE S00°00'00"E, 141.89 FEET;
 THENCE 343.94 FEET ALONG THE ARC OF A TANGENT CURVE TO THE LEFT, SAID ARC SUBTENDED BY A RADIUS OF 475.00 FEET, A CENTRAL ANGLE OF 41°29'14", AND A CHORD BEARING S20°44'37"E, 336.48 FEET;
 THENCE 343.94 FEET ALONG THE ARC OF A REVERSE CURVE TO THE RIGHT, SAID ARC SUBTENDED BY A RADIUS OF 475.00 FEET, A CENTRAL ANGLE OF 41°29'14", AND A CHORD BEARING S20°44'37"E, 336.48 FEET;
 THENCE S00°00'00"E, 201.56 FEET;
 THENCE ALONG THE NORTHERLY RIGHT OF WAY LINE OF STATE HIGHWAY 52 THE FOLLOWING TWO COURSES:
 1) S87°59'29"W, 174.29 FEET;
 2) S89°52'40"W, 2,242.61 FEET;
 THENCE N00°09'21"E, 894.03 FEET;
 THENCE S89°52'40"W, 883.89 FEET;
 THENCE N00°09'21"E, 1,683.89 FEET ALONG THE WESTERLY LINE OF THE SOUTHWEST QUARTER OF SECTION 36;
 THENCE N89°50'10"E, 1,325.25 FEET ALONG THE NORTHERLY LINE OF THE SOUTHWEST QUARTER OF THE NORTHEAST QUARTER OF SECTION 36;
 THENCE N00°11'59"E, 2,552.47 FEET ALONG THE WESTERLY LINE OF THE EAST HALF OF THE NORTHWEST QUARTER OF SECTION 36;
 THENCE N89°51'51"E, 1,312.16 FEET ALONG THE NORTHERLY LINE OF THE EAST HALF OF THE NORTHWEST QUARTER OF SECTION 36;
 THENCE N89°44'15"E, 2,625.18 FEET ALONG THE NORTHERLY LINE OF THE NORTHEAST QUARTER OF SECTION 36;
 THENCE S00°07'13"E, 2,656.28 FEET ALONG THE EASTERLY LINE OF THE NORTHEAST QUARTER OF SECTION 36 TO THE POINT OF BEGINNING, CONTAINING 471.70 ACRES, MORE OR LESS.

**MINER'S VILLAGE
 DISTRICT NUMBER 2
 FREDERICK, COLORADO**

SCALE	N/A		HURST & ASSOCIATES, INC. CONSULTING ENGINEERS
DATE	01/11/08		
ORG:	10/30/07	4072 Reed Blvd. Circle, Suite 100 Boulder, Colorado 80504 (303) 449-4125	
REV:	01/07/08	FILE C:\207247\SURVEY\LEGAL\047-DISTRICTS SHEET 1 OF 1	
REV:	01/11/08		